

Delegated Decision

21st July 2021

Highway Adoptions

Ordinary Decision



Report of Neighbourhoods & Climate Change

Paul Watson, Interim Strategic Highways Highway Manager

Electoral division(s) affected:

Blackhalls

Purpose of the Report

To consider those developments/schemes which have been proposed by developers and which require Section 38/278 Agreements to be entered into with them under the provisions of Section 38 & 278 of the Highways Act 1980 for the construction and subsequent adoption of the roads and footpaths, etc. which they are developing.

Recommendation

The details of the proposed works at Blackhall Colliery have been checked by Phillip Thompson from the Highway Adoptions Section, Neighbourhoods & Climate Change and are considered to be in accordance with Durham County Councils standards and specifications.

I therefore recommend that the Section 38/278 Agreements which will allow the works to proceed be entered into.

Background

Easington District

Agreement Type: Section 38/278 Agreement

Developer: Gleeson Regeneration Limited
Contact Address: 6 Europa Court
Sheffield Business Park
Sheffield
S9 1XE

Location: B1281, Hesleden Road, Blackhall Colliery

Details of Works: New three leg roundabout to access new residential development. New off-site footways and street lighting.

Agreement Type: Section 38 Agreement

Developer: Gleeson Regeneration Limited
Contact Address: 6 Europa Court
Sheffield Business Park
Sheffield
S9 1XE

Location: South of Hesleden Road, Blackhall Colliery

Details of Works: New residential access roads, parking bays, footways and street lighting.

Options

None

Main implications

Legal Implications

Once the works are complete, subject to them being satisfactory, they will be adopted. Once this happens Durham County Council will become responsible for the maintenance of the new highway (the new roads, footpaths, etc.)

Finance

Financed by private developers. Future maintenance will be carried out and financed by D.C.C, Neighbourhoods & Climate Change.

Conclusion

That the 38/278 Agreements detailed in the report be entered into.

Contact: Phillip Thompson

Tel: 03000 267106

Appendix 1: Implications

Legal Implications

Once the works are complete, subject to them being satisfactory, they will be adopted. Once this happens Durham County Council will become responsible for the maintenance of the new highway (the new roads, footpaths, etc.)

Finance

Financed by private developers. Future maintenance will be carried out and financed by D.C.C, Neighbourhoods & Climate Change.

Consultation

No

Equality and Diversity / Public Sector Equality Duty

It is considered that there are no Equality and Diversity issues to be addressed.

Climate Change

None

Human Rights

No impact on human rights

Crime and Disorder

Not affected

Staffing

None.

Accommodation

No impact.

Risk

Not applicable.

Procurement

Not applicable.

Durham County Council - IntraMAP

Agreement Type: Section 38/278 Agreement
Developer: Gleeson Regeneration Limited
Contact Address: 6 Europa Court
Sheffield Business Park
Sheffield
S9 1XE
Location: B1281, Hesleden Road, Blackhall Colliery
Details of Works: New three leg roundabout to access new residential development. New off-site footways and street lighting.

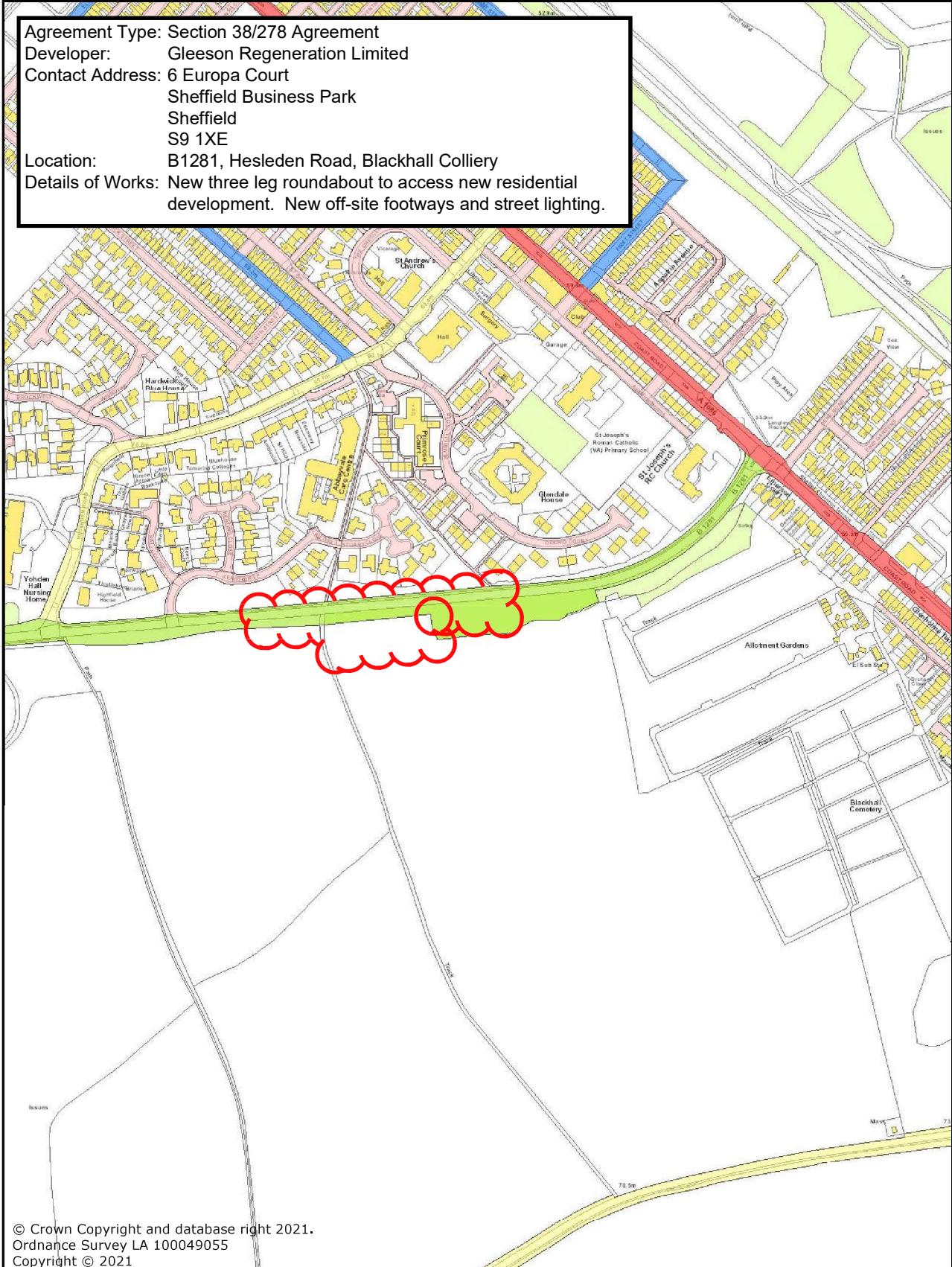

© Crown Copyright and database right 2021.
Ordnance Survey LA 100049055
Copyright © 2021

Every care has been taken to ensure the information contained on this map is correct. DCC accepts no liability for error or misinterpretation of the information shown on this map.



Map produced by Durham County Council - IntraMAP on 20/7/2021 at a scale of 1:5000

GENERAL NOTES:
1. ALL WORKS TO BE COMPLETED WITHIN THE SPECIFIED PERIOD.
2. ALL WORKS TO BE COMPLETED WITHIN THE SPECIFIED PERIOD.
3. ALL WORKS TO BE COMPLETED WITHIN THE SPECIFIED PERIOD.
4. ALL WORKS TO BE COMPLETED WITHIN THE SPECIFIED PERIOD.
5. ALL WORKS TO BE COMPLETED WITHIN THE SPECIFIED PERIOD.
6. ALL WORKS TO BE COMPLETED WITHIN THE SPECIFIED PERIOD.
7. ALL WORKS TO BE COMPLETED WITHIN THE SPECIFIED PERIOD.
8. ALL WORKS TO BE COMPLETED WITHIN THE SPECIFIED PERIOD.
9. ALL WORKS TO BE COMPLETED WITHIN THE SPECIFIED PERIOD.
10. ALL WORKS TO BE COMPLETED WITHIN THE SPECIFIED PERIOD.

REVISIONS:
1. ALL WORKS TO BE COMPLETED WITHIN THE SPECIFIED PERIOD.
2. ALL WORKS TO BE COMPLETED WITHIN THE SPECIFIED PERIOD.
3. ALL WORKS TO BE COMPLETED WITHIN THE SPECIFIED PERIOD.
4. ALL WORKS TO BE COMPLETED WITHIN THE SPECIFIED PERIOD.
5. ALL WORKS TO BE COMPLETED WITHIN THE SPECIFIED PERIOD.
6. ALL WORKS TO BE COMPLETED WITHIN THE SPECIFIED PERIOD.
7. ALL WORKS TO BE COMPLETED WITHIN THE SPECIFIED PERIOD.
8. ALL WORKS TO BE COMPLETED WITHIN THE SPECIFIED PERIOD.
9. ALL WORKS TO BE COMPLETED WITHIN THE SPECIFIED PERIOD.
10. ALL WORKS TO BE COMPLETED WITHIN THE SPECIFIED PERIOD.

S278 KEY
EXTENT OF AREA SUBJECT TO S278 WORKS
EXTENT OF EXISTING ADAPTED HIGHWAY
EXISTING HIGHWAY TO REMAIN
PROPOSED NEW HIGHWAY GULLY AND LEAD
EXISTING HIGHWAY TO REMAIN
PROPOSED NEW HIGHWAY GULLY AND LEAD

REFER TO RWD DRAWING NO. D800 SECTION 38
PLAN FOR EXTENTS OF SECTION 38 WORKS

SUBJECT TO LOCAL AUTHORITY
APPROVAL

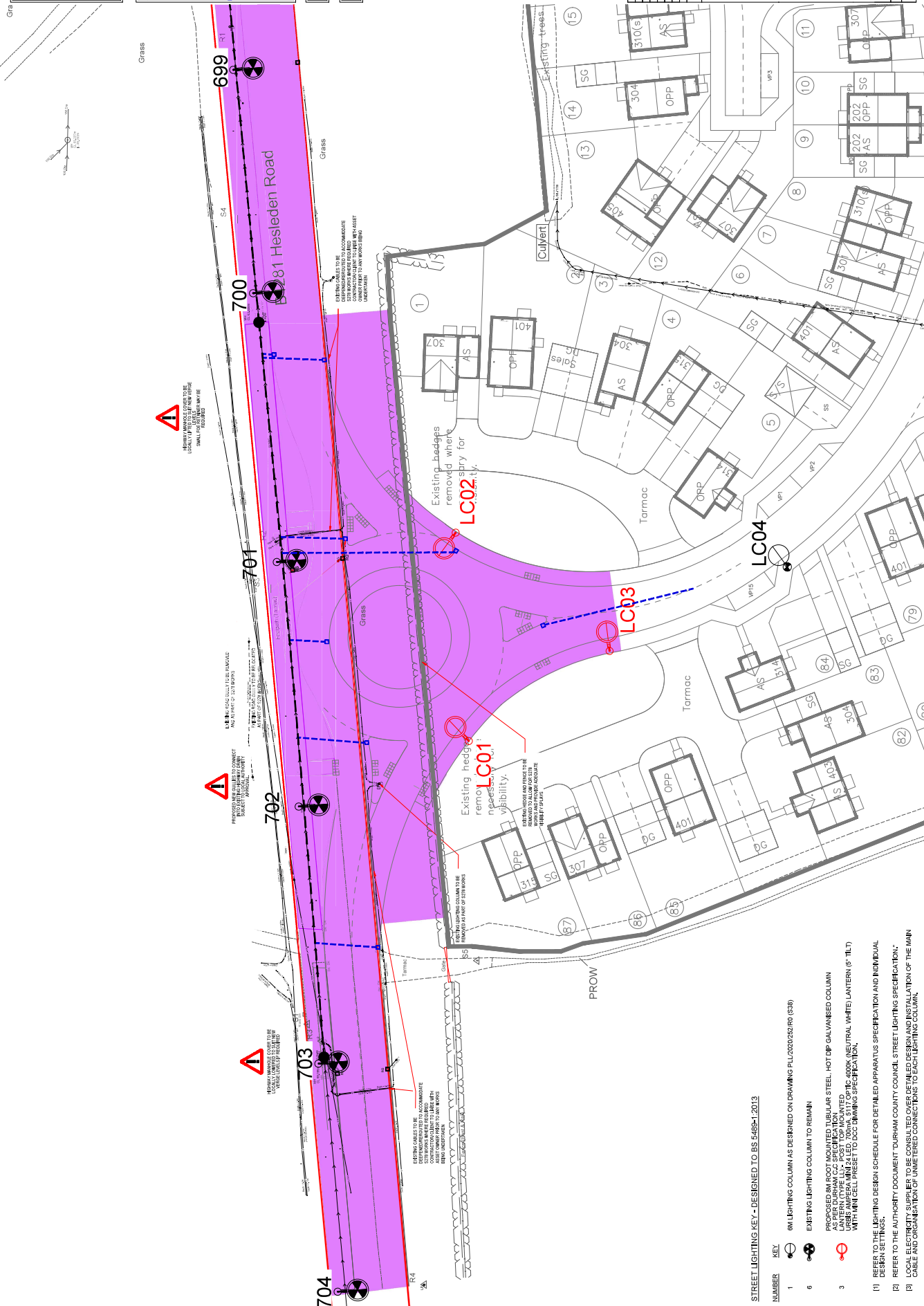

NO.	REVISION	DATE	BY
1	ISSUED FOR TENDER	20/02/2020	RS
2	REVISED TO INCLUDE COMMENTS	03/03/2020	RS
3	REVISED TO INCLUDE COMMENTS	03/03/2020	RS
4	REVISED TO INCLUDE COMMENTS	03/03/2020	RS
5	REVISED TO INCLUDE COMMENTS	03/03/2020	RS
6	REVISED TO INCLUDE COMMENTS	03/03/2020	RS
7	REVISED TO INCLUDE COMMENTS	03/03/2020	RS
8	REVISED TO INCLUDE COMMENTS	03/03/2020	RS
9	REVISED TO INCLUDE COMMENTS	03/03/2020	RS
10	REVISED TO INCLUDE COMMENTS	03/03/2020	RS

FOR APPROVAL

WITNESSED BY:
RWD CONSULTING ENGINEERS
11/11/2020

APPROVED BY:
RWD CONSULTING ENGINEERS
11/11/2020

PROJECT:
GLEESON HOMES
HESLEDEN ROAD
BLACKHALL COLLIERY
PROPOSED S278 PLAN

DATE OF SCALE: 1:500 (PLAN)
DATE OF SCALE: 1:100 (SECTION)
SCALE: 1:500 (PLAN)
SCALE: 1:100 (SECTION)
DRAWN: Y17039
CHECKED: D1000
DATE: 11/11/2020
PAGE: 1 OF 1

STREET LIGHTING KEY - DESIGNED TO BS 5489-1:2013

NUMBER

1. 6M LIGHTING COLUMN AS DESIGNED ON DRAWING PL2/2020/252/RO (S38)

6. EXISTING LIGHTING COLUMN TO REMAIN
AS PER DURHAM C.C SPECIFICATION
AS PER DURHAM C.C SPECIFICATION
UNLESS OTHERWISE NOTED
WITH MINI CELL PRESET TO DCC DIMMING SPECIFICATION.

3. PROPOSED 6M FOOT MOUNTED TUBULAR STEEL - HOT DIP GALVANISED COLUMN
AS PER DURHAM C.C SPECIFICATION
UNLESS OTHERWISE NOTED
WITH MINI CELL PRESET TO DCC DIMMING SPECIFICATION.

[1] REFER TO THE LIGHTING DESIGN SCHEDULE FOR DETAILED APPARATUS SPECIFICATION AND INDIVIDUAL DESIGN SETTINGS.

[2] REFER TO THE AUTHORITY DOCUMENT DURHAM COUNTY COUNCIL STREET LIGHTING SPECIFICATION - CABLE AND ORGANISATION OF UNARMED CONNECTIONS TO EACH LIGHTING COLUMN.

Durham County Council - IntraMAP

Agreement Type: Section 38 Agreement
Developer: Gleeson Regeneration Limited
Contact Address: 6 Europa Court
Sheffield Business Park
Sheffield
S9 1XE
Location: South of Hesleden Road, Blackhall Colliery
Details of Works: New residential access roads, parking bays, footways
and street lighting

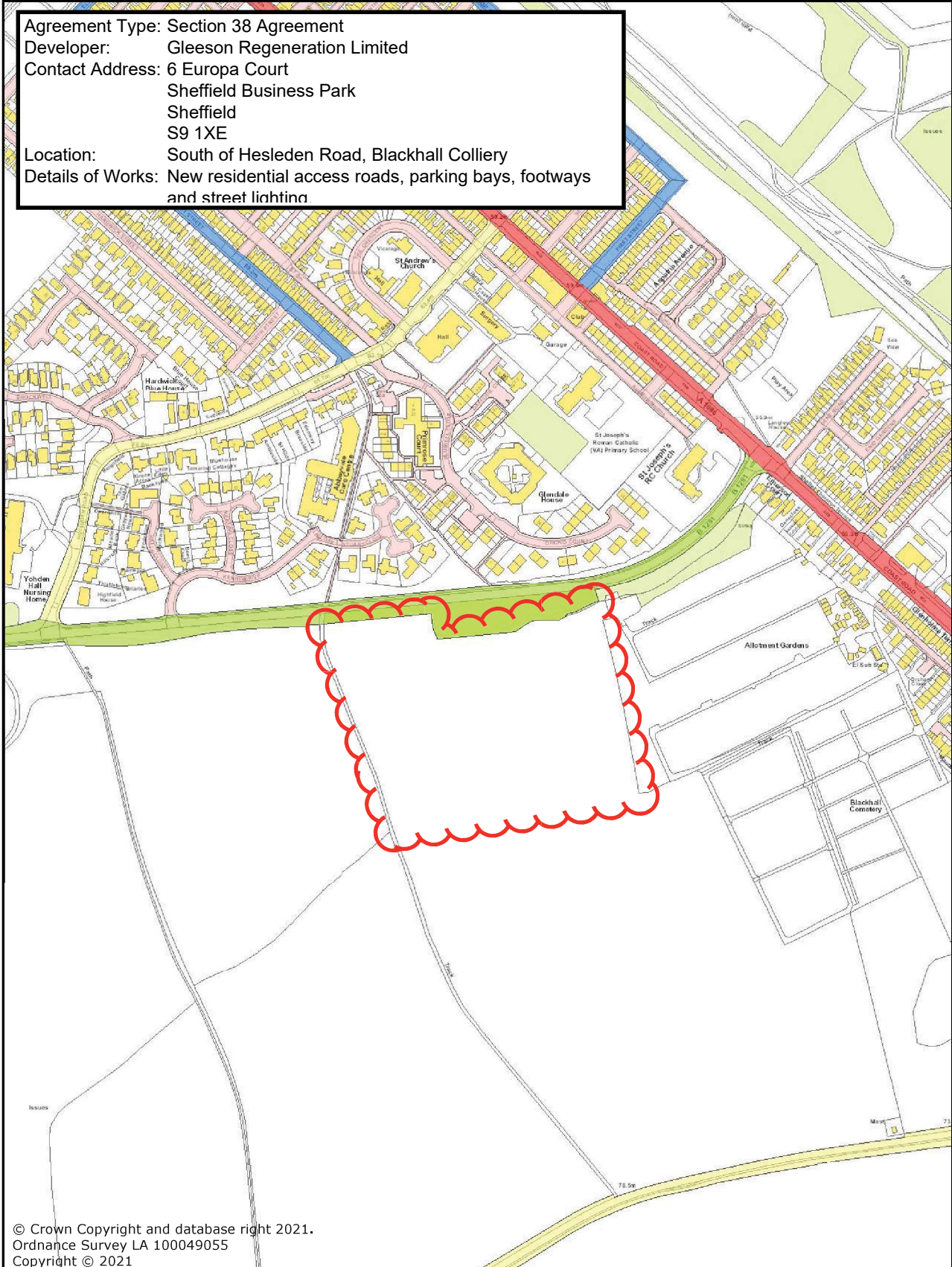

© Crown Copyright and database right 2021.
Ordnance Survey LA 100049055
Copyright © 2021

Every care has been taken to ensure the information contained on this map is correct. DCC accepts no liability for error or misinterpretation of the information shown on this map.



Map produced by Durham County Council - IntraMAP on
20/7/2021 at a scale of 1:5000

